

12' Island **Hot** Food Bar

with End Container & Rice Warmer Shelf

IP #IHFB12666-BP3-DR3-ECS-IHW-GC-VH

12'-0" L x 68" D x 53" H

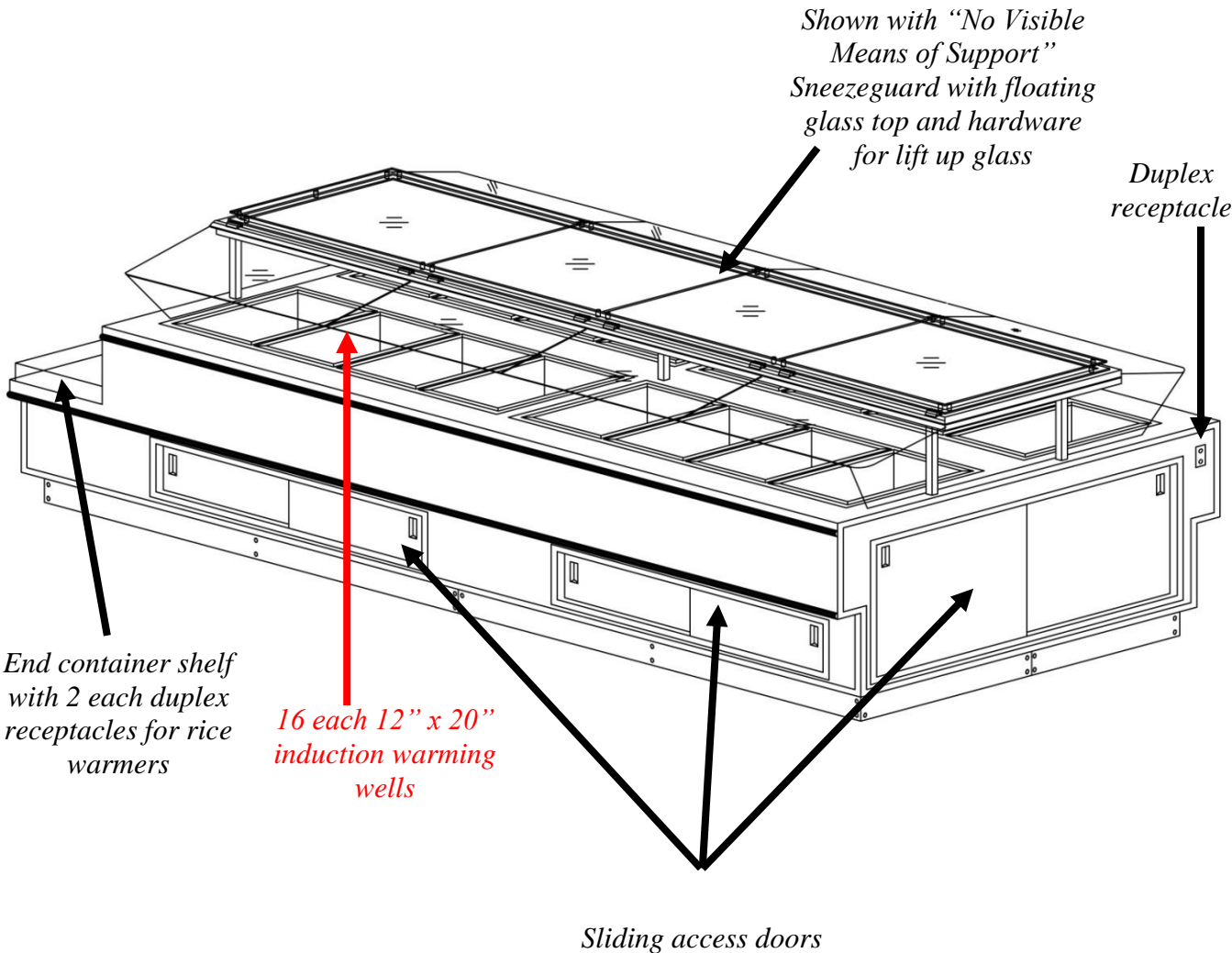

Approval – Complete All Sections

Colors:

Body:

Laminate: Mfr. _____

Color: Decatone Surfaces TC-4525GR

Sheeshamo Grain Finish # _____

If wood grain laminate – direction of grain. Vertical Horizontal

Bumper: _____

Kick plates: Black

Countertop:

Granite: Mfr. _____

Color New Venetian Gold # _____

Electric:

Voltage 120/208V

Phase: Three

Source: Floor

Delivery

Site: Loading Dock Ground Level

Delivery hours: _____

Depth of case is 68" which will fit through narrowest space between delivery point and install location. Yes No If no – CALL US ASAP

Approval signature: _____

Date: _____

See last page for specifications table – your signature above verifies the installation site has the required power as shown



Atlantic Food Bars
Hot Food Merchandising
Equipment Specialists

888-MEAL-SOLUTIONS (888-632-5765)
www.atlanticfoodbars.com

Scroll down for more views

12' Island **Hot Food Bar**

with End Container & Rice Warmer Shelf

IP #IHFB12666-BP3-DR3-ECS-IHW-GC-VH

12'-0" L x 68" D x 53" H

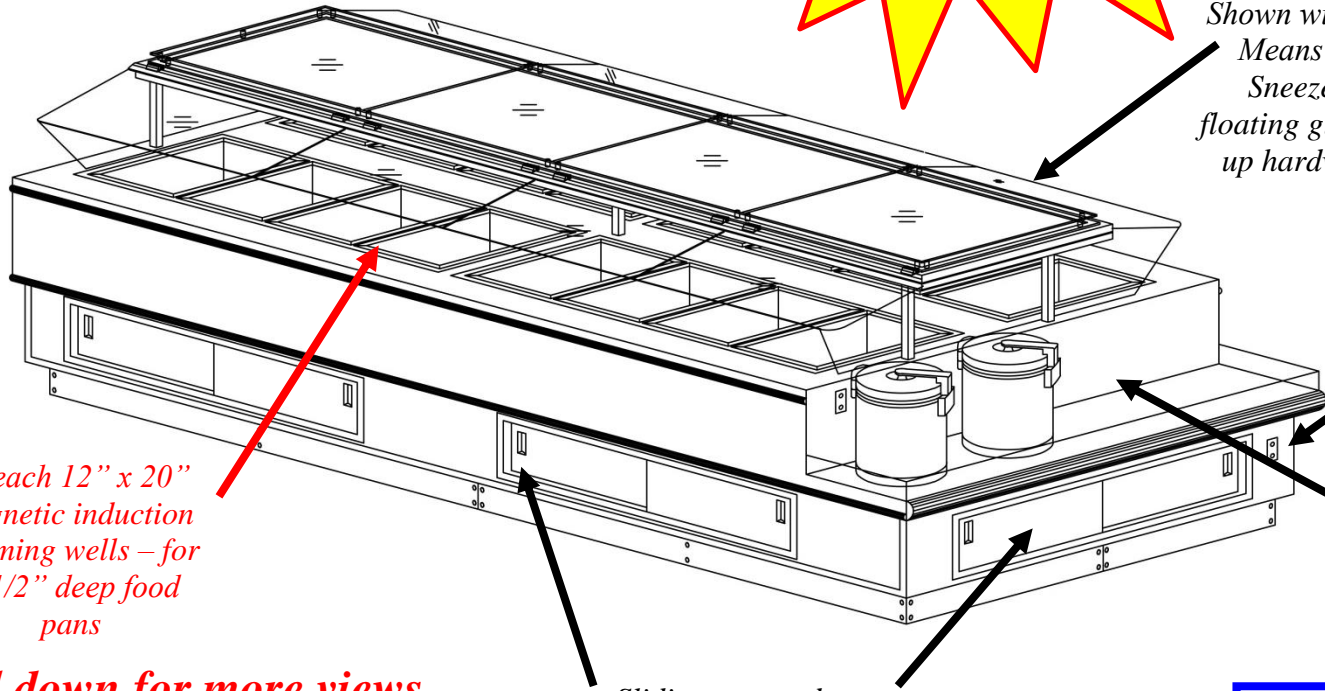

Shown with "No Visible Means of Support" Sneezeguard with floating glass top and lift up hardware on glass

Duplex receptacle

End container shelf With 2 each duplex receptacles for rice warmers

16 each 12" x 20" magnetic induction warming wells – for 2-1/2" deep food pans

Sliding access doors

Scroll down for more views

Details per sign off on page 1 and specifications on page 4

Approval signature: _____

Date: _____

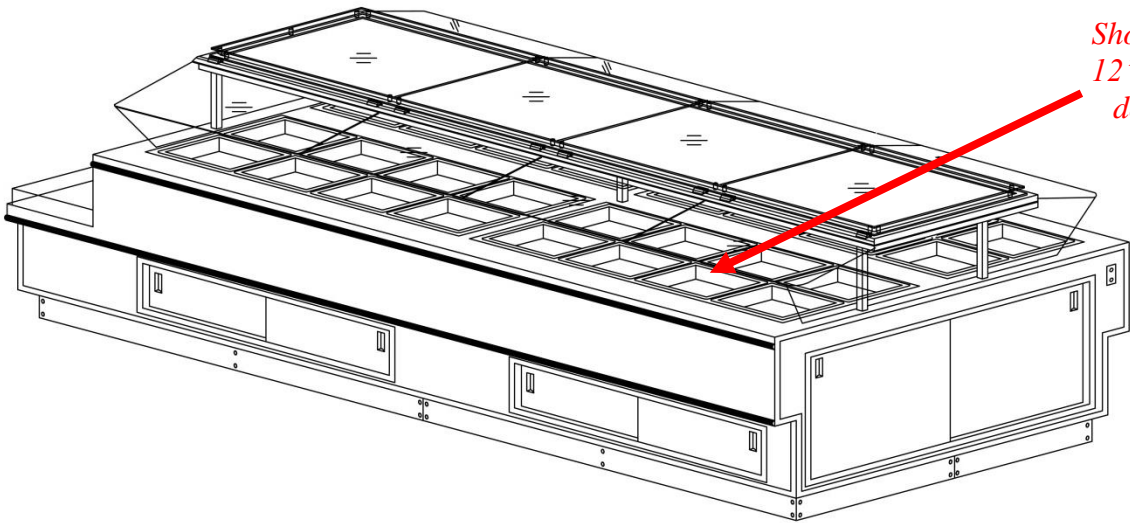

Shown with 1/2 size 12" x 10" x 2-1/2" deep food pans



HOT
Atlantic Food Bars
Hot Food Merchandising
Equipment Specialists

888-MEAL-SOLUTIONS (888-632-5765)
www.atlanticfoodbars.com

12' Island **Hot** Food Bar

with End Container & Rice Warmer Shelf

IP #IHFB12666-DR3-ECS-IHW-GC-VH

12'-0" L x 68" D x 53" H

Details per sign off on page 1 and specifications on page 4

Approval signature: _____

Date: _____

Plan View

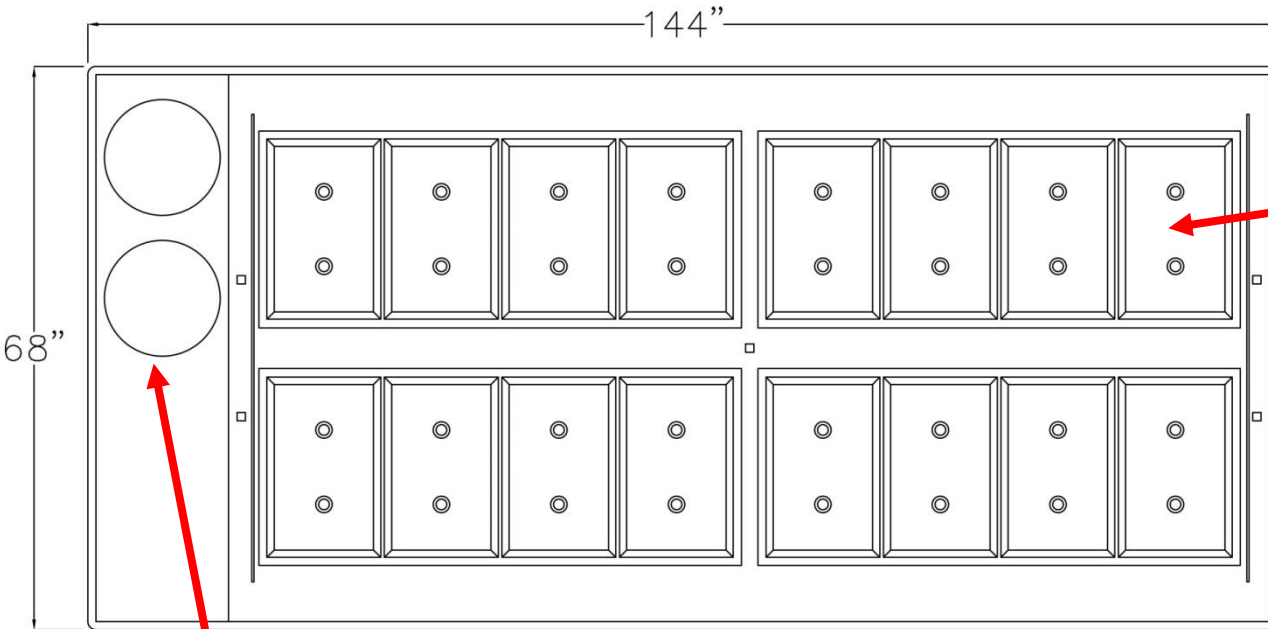

*Magnetic induction food warming wells
- Capacity 32 each
12" x 10" x 2-1/2" deep half size pans*

Scroll down for more views

2 each rice warmers by others

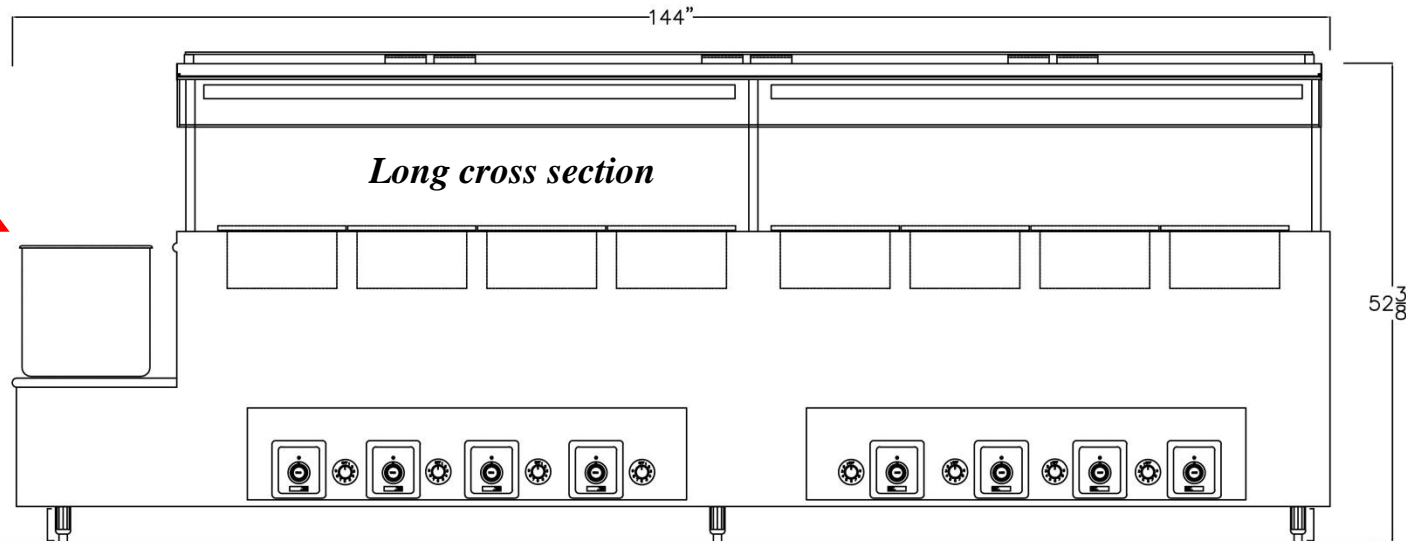

Atlantic Food Bars
Hot Food Merchandising
Equipment Specialists

888-MEAL-SOLUTIONS (888-632-5765)
www.atlanticfoodbars.com

12' Island **Hot Food Bar**

with End Container & Rice Warmer Shelf

IP #IHFB12666-BP3-DR3-ECS-IHW-GC-VH
12'-0" L x 68" D x 53" H

Details per sign off on page 1 and specifications on page 4

Approval signature: _____

Date: _____

Cross Sections

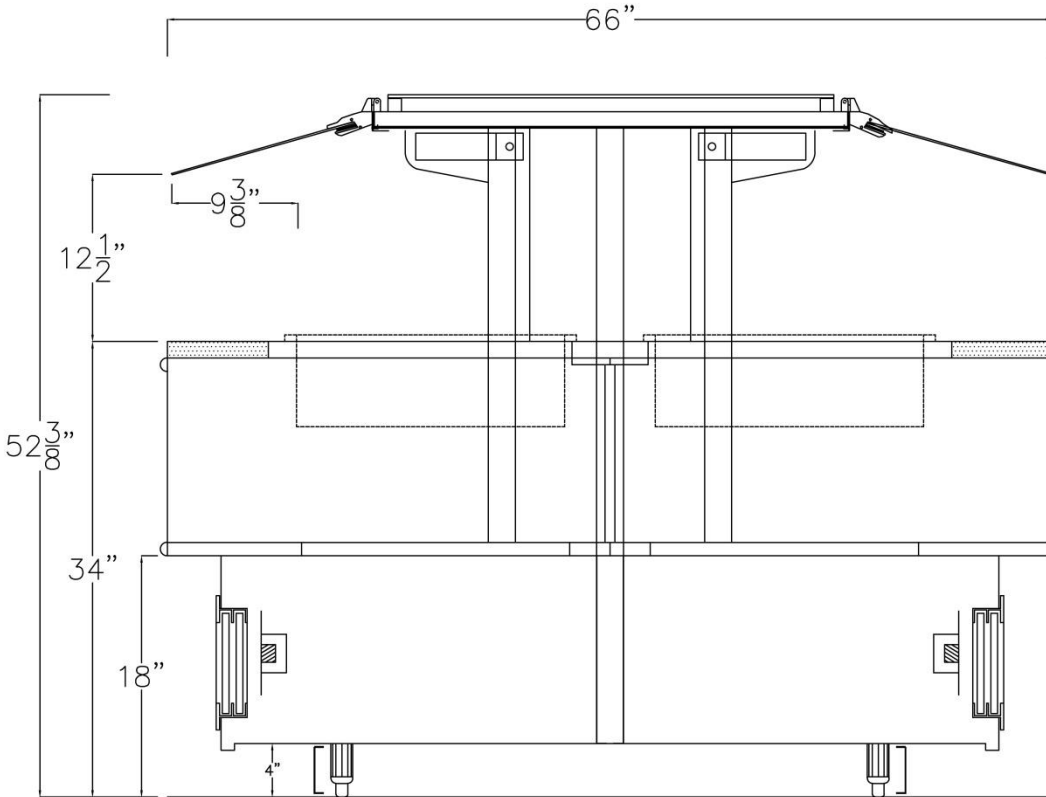

*Cross Section
Rice Cooker End Shelf*
(Rice warmers by others)

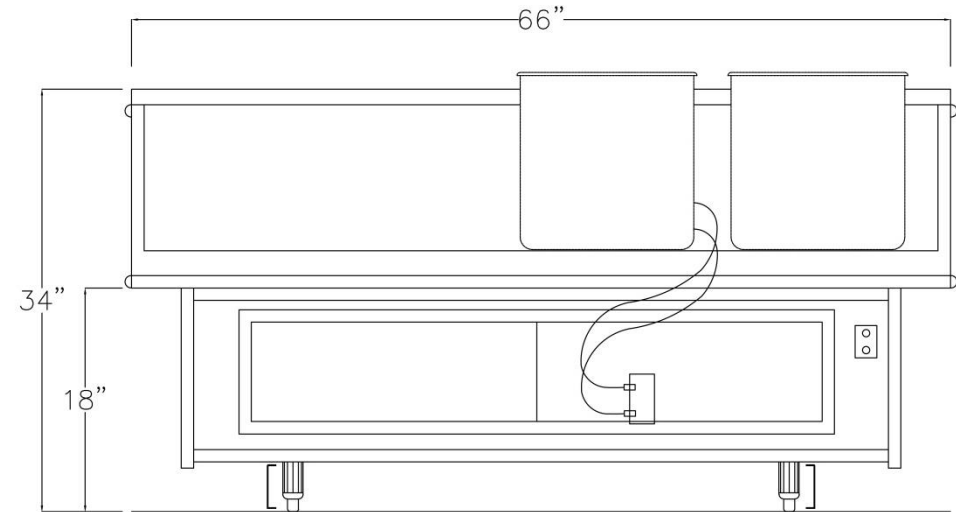

<i>Internal Part #</i>	<i>Custom Description</i>	<i>Dimensions</i>	<i>Voltage</i>	<i>Amps 3 Ph</i>	<i>12" x 20" Hot Well Capacity</i>
IHFB12666-BP3-DR3-ECS-IHW-GC-VH	12' Island Hot Food Bar	12'-0" L x 68" W x 53" H	120/208	77.3 *	16
*PLUS (3) 120V 20-amp duplex receptacles					

Atlantic Food Bars
Hot Food Merchandising
Equipment Specialists

888-MEAL-SOLUTIONS (888-632-5765)
www.atlanticfoodbars.com