

Narrow Island Olive Bar with End Container Shelf

Estate Series

IP # ISBN17838-ECS-ES
16'-0" L x 40 1/2" D x 53 1/2" H

16' unit shown with
13 full size 12" x 20"
pan openings

Approval – Complete All Sections

Colors:

Body: Laminate : Yes Mfr. _____

Color _____ # _____

If woodgrain laminate – direction of
grain Vertical ___ Horizontal ___

Bumper: N/A

Countertop: Granite

Color _____

Refrigeration :

Remote Refrigerant _____

Electric :

Voltage 120V

Phase : Single

Source : Ceiling _____ Floor _____

Delivery

Site: Loading Dock ___ Ground Level ___

Delivery hours : _____

Depth of case is 40 1/2" which will fit through
narrowest space between delivery point and install
location Yes ___ No ___ If no – CALL US ASAP

Approval signature: _____

Date: _____

See last page for specifications table – your
signature above verifies the installation site has the
required power as shown

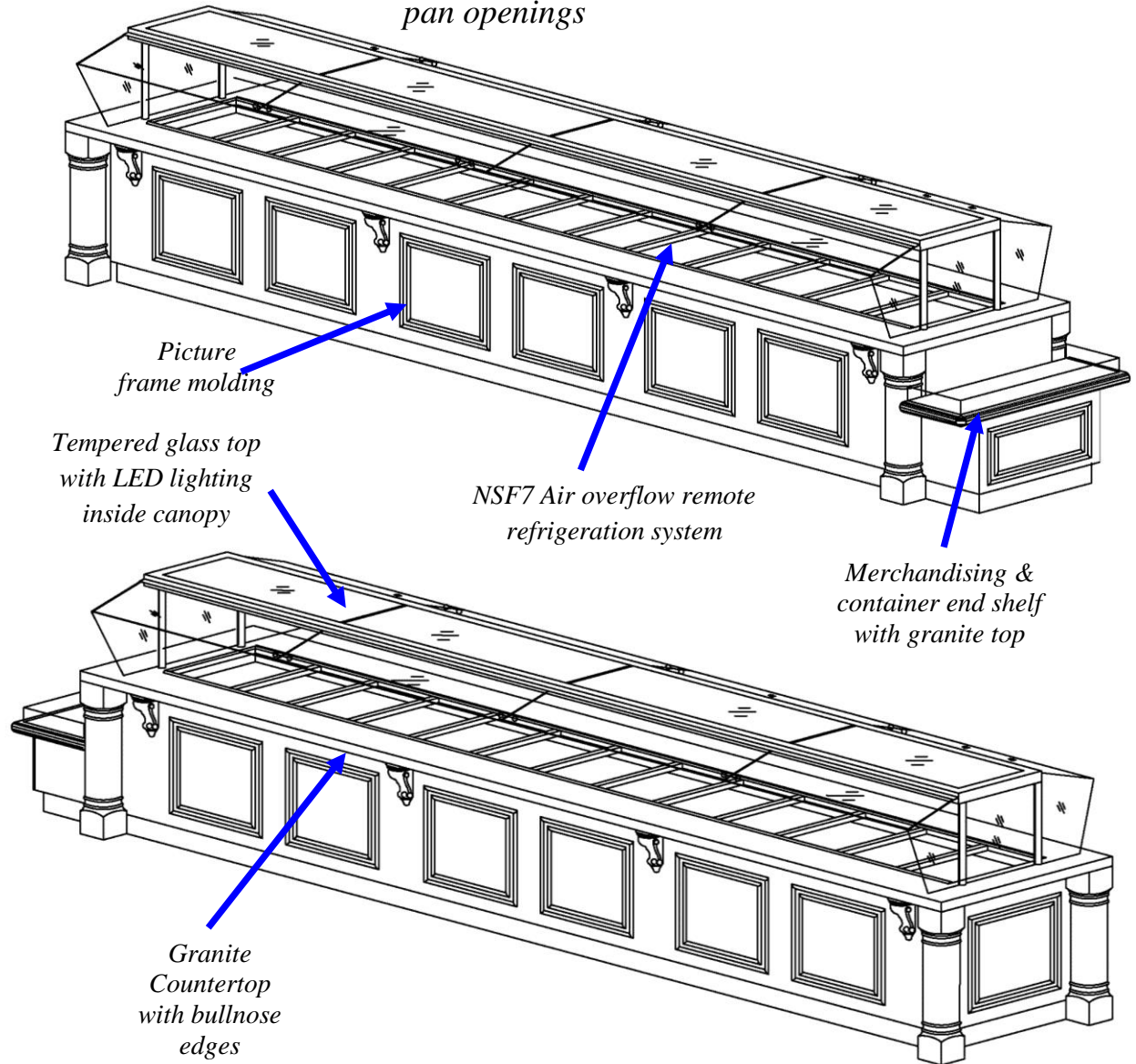

Atlantic Food Bars
Your **HOT & COLD** Food Equipment Specialist !
888-MEAL-SOLUTIONS (888-632-5765)
www.atlanticfoodbars.com

Narrow Island Olive Bar with End Container Shelf

Estate Series

IP # ISBN17838-ECS-ES
16'-0" L x 40 1/2" D x 53 1/2" H

Details per sign off on page 1 and
specifications on last page

Approval signature: _____

Date: _____

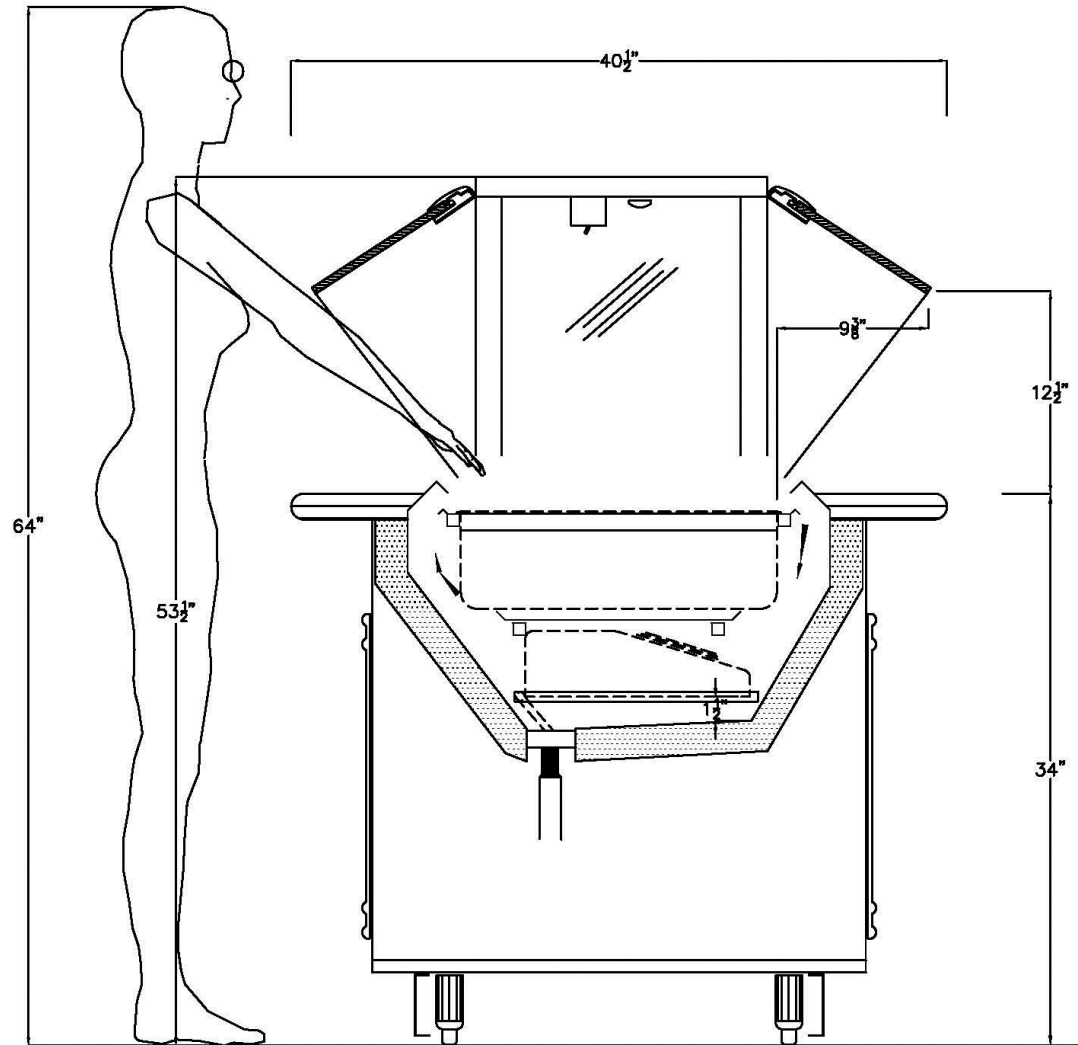

Short Cross Section



Atlantic Food Bars
Your **HOT & COLD** Food Equipment Specialist!
888-MEAL-SOLUTIONS (888-632-5765)
www.atlanticfoodbars.com

Narrow Island Olive Bar with End Container Shelf

Estate Series

IP # ISBN17838-ECS-ES
16'-0" L x 40 1/2" D x 53 1/2" H

Details per sign off on page 1 and
specifications on last page

Approval signature: _____

Date: _____

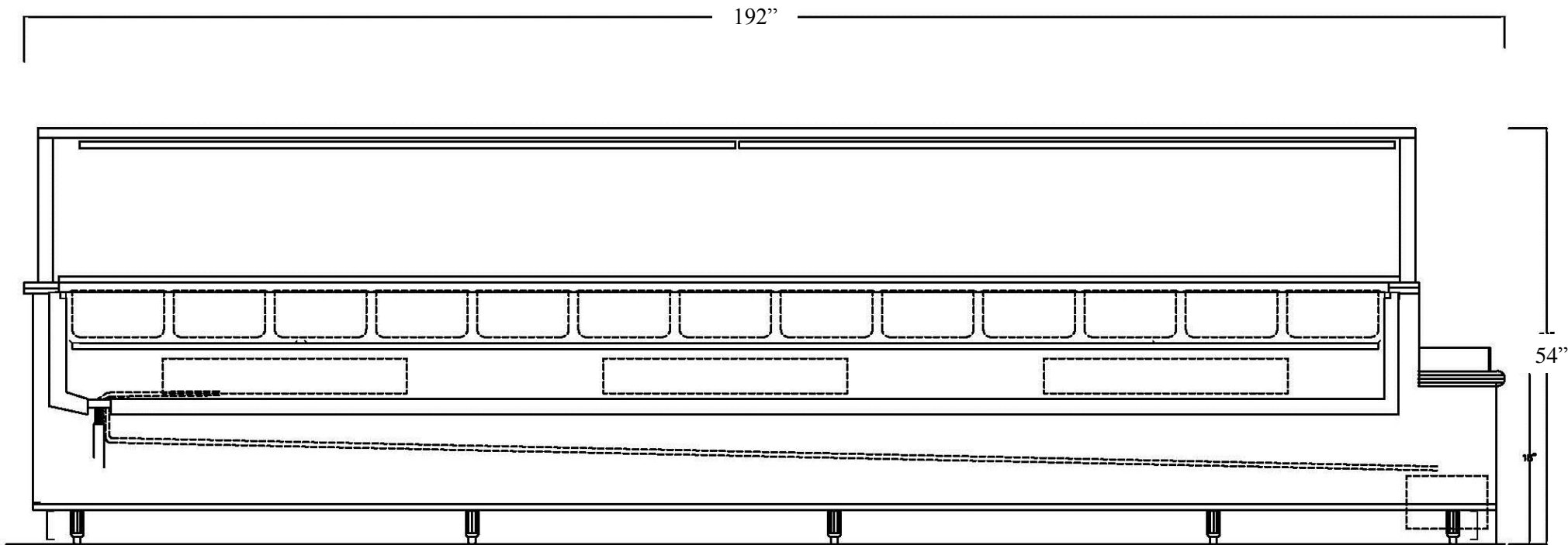

Long Cross Section



Atlantic Food Bars
Your **HOT & COLD** Food Equipment Specialist!
888-MEAL-SOLUTIONS (888-632-5765)
www.atlanticfoodbars.com

Narrow Island Olive Bar with End Container Shelf

Estate Series

IP # ISBN17838-ECS-ES
16'-0" L x 40 1/2" D x 53 1/2" H

Details per sign off on page 1 and
specifications on last page

Approval signature: _____

Date: _____

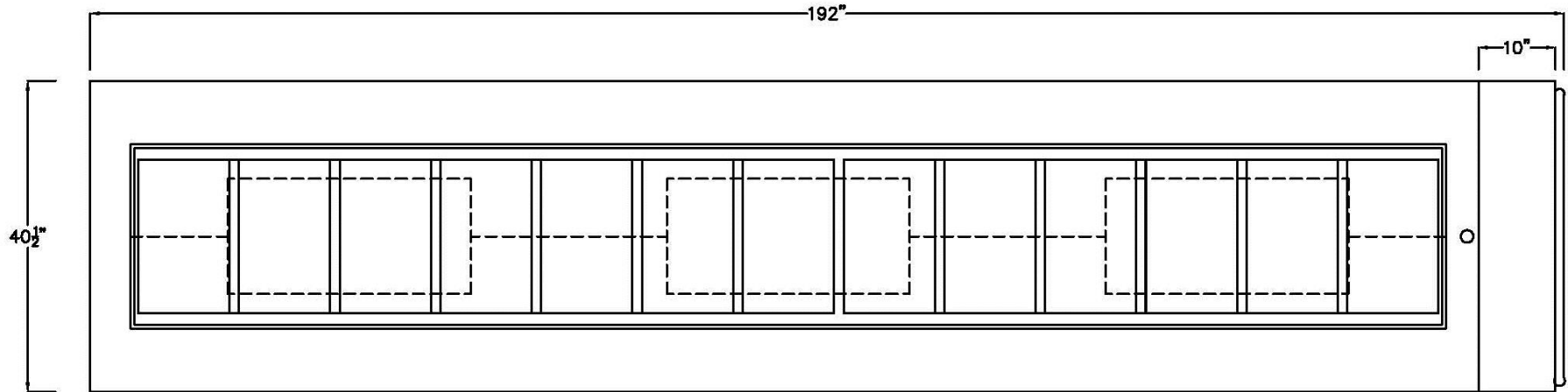

Plan View

Internal Part #	Custom Description	Dimensions	Voltage	Remote Refrigeration	12" x 20" Pan Capacity	BTU
				Amps 1 Ph		
ISBN17838-ECS-ES	16' Narrow Island Olive Bar	16'-0" L x 40 1/2" D x 53 1/2" T	120	9.6	13	9,000
Maximum overcurrent protection = 15 amps; 25° suction temp						



Atlantic Food Bars
Your **HOT & COLD** Food Equipment Specialist!
888-MEAL-SOLUTIONS (888-632-5765)
www.atlanticfoodbars.com